

Mercury House, 8, Bath Road, Slough, SL1

Guide Price £275,000

 2  1  1



TWO BEDROOM - BALCONY - LIFT - LEASEHOLD - CHAIN FREE

Henry Wiltshire are pleased to introduce this well maintained two bedroom apartment which comprises of double bedrooms, open plan kitchen/living room, balcony, wooden flooring throughout, and lift access. This property is located just 0.5 miles to Slough train station, and 1.1 miles to Herschel Grammar School.

Ideal for first time buyers and investors alike. Contact a member of staff now for more details.

- Two Bedroom
- Balcony
- Wooden Floors
- Lift Access
- Leasehold
- Chain Free
-
-

Mercury House, Bath Road, Slough, SL1

APPROX. GROSS INTERNAL FLOOR AREA 569 SQ FT 52.8 SQ METRES

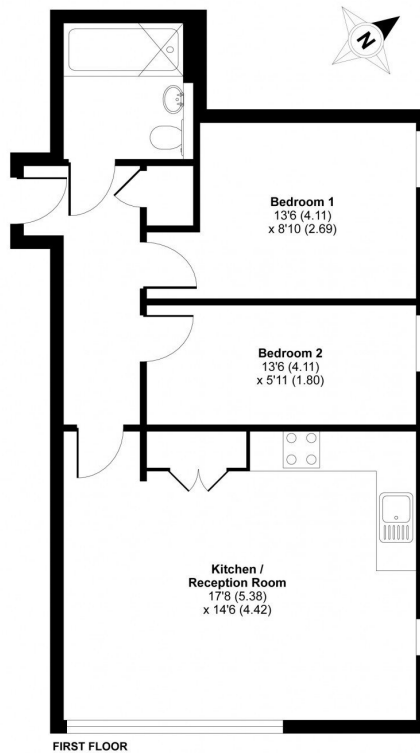

Whilst every attempt has been made to ensure the accuracy of the floor plan contained here, measurements of doors, windows and rooms are approximate and no responsibility is taken for any error, omission or misstatement. These plans are for representation purposes only as defined by RICS Code of Measuring Practice and should be used as such by any prospective purchaser. Specifically no guarantee is given on the total square footage of the property if quoted on this plan. Any figure given is for initial guidance only and should not be relied on as a basis of valuation.

Copyright nichecom.co.uk 2017 Produced for Henry Wiltshire REF : 213346